

DESIGNED BY ARCHITECTURE, E.W. Aschmann 1/54
 PLANS AND DESIGN Hodge, J. Hanson 1/54
 ENGINEERING O'Neil 1/54

REVIEWED RESEARCH AND EDUCATION
 SANITATION

CLEARED REGIONAL DIRECTOR

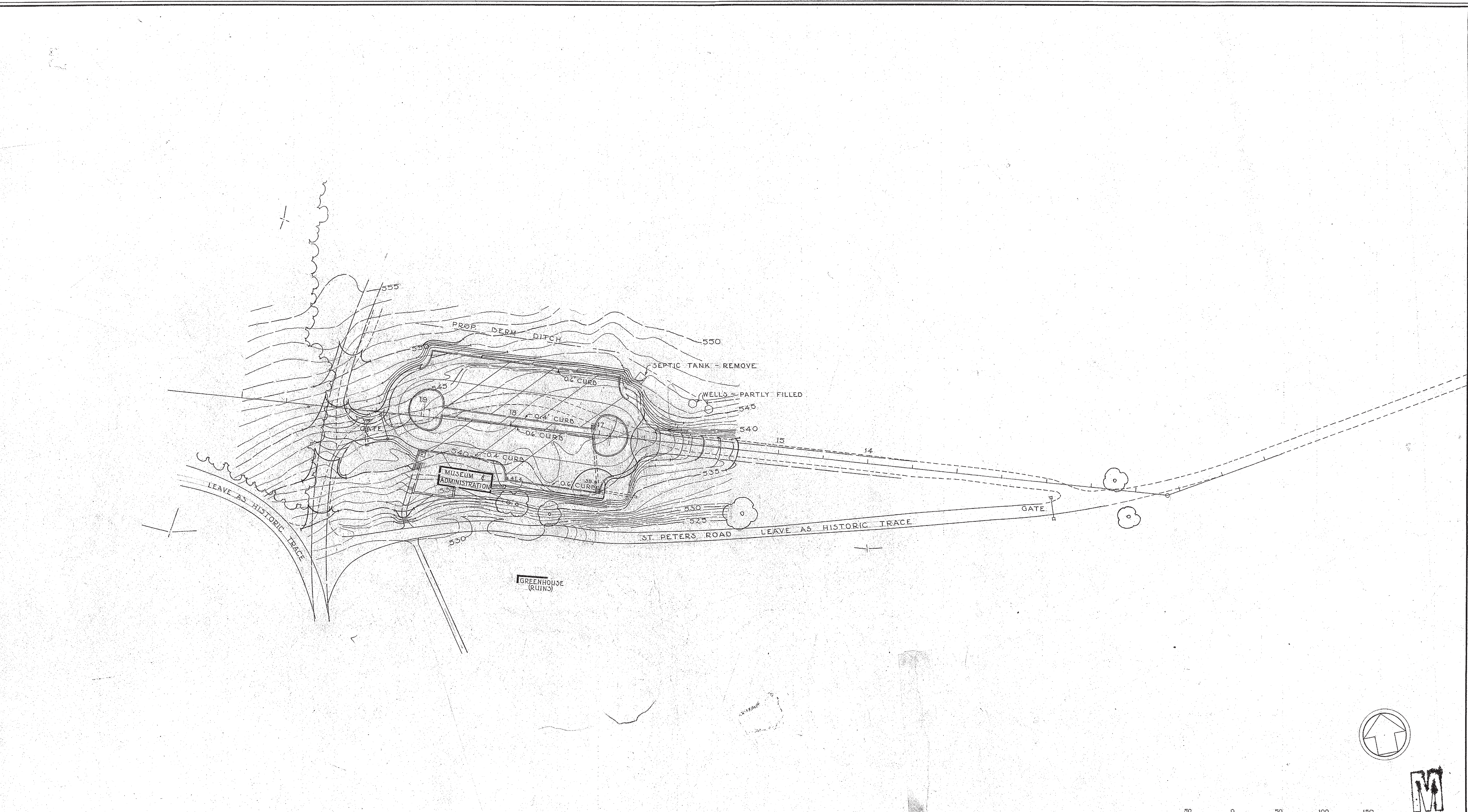

BASIC DATA NHS-HV 2018-C
 SURVEY BY T.E. RUFFIN

WORKING DRAWING

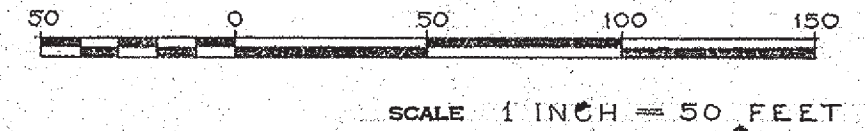

RECOMMENDED CATHERINE M. FRITZ ACT'G SUPERINTENDENT DATE 3/4/54 By Memo	UNITED STATES DEPARTMENT OF THE INTERIOR NATIONAL PARK SERVICE DESIGN & CONSTRUCTION DIVISION REGIONAL OFFICE	REGION 1
		SHEET 1 OF 1
RECOMMENDED EDWARD S. ZIMMER ASST. REGIONAL DIRECTOR DATE 3/9/54 CONCURRED	GRADING PLAN OF THE HEADQUARTERS DEVELOPMENT NAME OF JOB HOPEWELL VILLAGE LOCATION HOPEWELL VILLAGE NATIONAL HISTORIC SITE NAME OF PARK OR MONUMENT	DRAWING NO. NHS-HV 2022
APPROVED ELBERT COX DIRECTOR DATE 3/9/54		

